

Member since June 1988

NEXT MEETING
November 20
6:45 p.m.

NEXT MONTH
Deadline for
November Issue
December 1, 2014

MEMBERSHIP
126

ATTENDANCE PRIZE

Norm Ness won the Attendance Prize. Maybe next meeting it will be **YOU!**

Will your name be drawn on

November 20?

You have to be present to win!

BOTTLES FOR BASICS

- ◆ Total LAST YEAR
- ◆ \$736.48
- ◆ YEAR TO DATE:
- ◆ \$350.23
- ◆ THIS MONTH:
- ◆ \$67.00

Donations of Used Ink and Toner Cartridges:
 Last Month:\$12.00
 Year to Date:
 \$106.00

The Signal

The Great Falls Model Railroad Club



VOLUME 36. ISSUE 6

NOVEMBER 2014



EX-TRAIN-AGANZA: CLUB'S MAJOR EVENT



By Paul Lodge

One of the club's major fund-raising events is the five-day Ex-TRAINaganza, which starts the Christmas season for the club.

As children come into the meeting room, they will write their names on paper locomotives and pin them to a five-foot Christmas tree painted on homasote. During the event, children will be able to run trains as guest engineers, win prizes from the "Roundhouse Roulette" game, make crafts at the crafts table, and decorate cookies and Christmas ornaments. Young children will also be able to play with the train toys on the play rug. Visitors can purchase t-shirts, railroad books, engineer hats, train whistles, Christmas cards, cookie cutters, and items from our surplus inventory supplies.

On November 29, the last day of the ExTRAINaganza, winning tickets will be drawn for the three train sets under the Christmas trees, the club's Raffle Layout, the "12 Gifts of Christmas," and the afghan.

Because of the number of days and the different activities going on at the event, club members are needed to help by taking charge of games, supervising craft and cookie tables, selling tickets, monitoring layouts, and teaching young "Guest Engineers" how to run trains.

The Great Falls Model Railroad Club holds the ExTRAINaganza during the same times as the FEZtival of Trees sponsored by the Shriners in Lewiston so that visitors can enjoy them both on the same or alternate days.

The ExTRAINaganza is a five-day event with different times each day. It starts on Saturday, November 22, from 10 a.m. to 8 p.m. and continues Sunday, November 23, from 10 a.m. to 4 p.m. and Monday evening from 4 to 8. On the Friday after Thanksgiving, the event will start at 10 a.m. and go to 8 p.m. Saturday, November 29, the last day of ExTRAINaganza, we will start at 10 a.m. and finish at 4 p.m.



MEET THE MEMBERS

By Maurice Fortin

ROGER PLUMMER



Roger Plummer lives in Lewiston and has been married to Julie for 17 years. He is probably one of the few people who can say that he played with Tonka trucks and railroad trains as a child and has continued to do the same thing as an adult. His working career began with 13 years in construction at Hillside Construction and R. J. Grondin Construction. For the last 18 years he has worked for the St. Lawrence and Atlantic Railroad as a Locomotive Maintainer. He has an engineer's certificate, which allows him to drive the locomotives in the rail yard.

Roger started with model railroading when his grandfather gave him a hand-me-down Lionel train. His biggest influence for railroading was his grandfather, who worked at the Portland terminal of the Maine Central Railroad. Roger was able to ride with him on the PT1055 on the 3 – 11 shift, switching cars at the Rigby Yard. Sounds like fun!

Roger has been involved with model railroading for over 20 years. He was active for many years in the Portland Terminal Railroad Club and became active with GFMRRRC about four years ago. His favorite railroad is the HO layout. Roger has been involved in ballasting and scenery for the HO layout, including customizing vehicles. He also enjoys working with the children and Junior Master Model Railroaders on the Saturday operating sessions. He currently has a small switching layout at home, but he is planning that his retirement gauge will be G scale.

Fred Hirsch got Roger involved with Operation Lifesaver, but he has not been able to do presentations because of his schedule.

Other activities that Roger enjoys include Maine Vintage Car Racing, for which he is on the Board of Directors. He has also enjoyed bowling for the last 37 years and is a Hall of Fame member. He has had a high game of 294 and 20 games with scores of 279.

One of Roger's special contributions to the railroad club is changing the words on the bulletin board outside the club so that everyone will know about upcoming and current events.



ANNUAL AUBURN

TRAIN SHOW

By Paul Lodge

On Saturday, November 1, the Great Falls Model Railroad Club sponsored its annual train show at the Auburn Middle School. Hundreds of railroad enthusiasts, including many families, attended. About sixty-five club members came to help or support the event.

As patrons entered, they had the opportunity to buy tickets on the raffle layout and the train afghan. Free Operation Lifesaver handouts were available. At the craft table, people could buy bumper stickers, train-themed greeting cards, cookie cutters in the shape of locomotives and cabooses, and pillows, potholders and locomotive doorstops made by Carmen Coulombe.

The club's large modular layout filled nearly half of the cafeteria and the N-scale layout was also in the room. Bob Willard and Greg Ouellette's On30 layout was in the gym with the sales tables. Phil Clough had his test track available so people could be sure locomotives were operational before they bought them.

A new feature this year was the square-foot model contest. There were six models from which people could vote for the "People's Choice" award. Bob Willard's model won the contest, but it was a close vote. The other displays were also well made and highly detailed.

The Auburn Music Association sold refreshments as their major fund-raiser, offering home-made desserts and other foods.

After the show about twenty club members went to Governor's Restaurant to celebrate and enjoy each other's company after a successful day.

HELP WANTED

By Jerry Johnston

Often we are asking for money. This time we are asking for help. The club has a large inventory of boxcars that could use some small repairs with wheels and couplers. The club also has a large inventory of buildings that could use some repair, painting and installation of windows, etc. All of the work is simple and easy. The club has all the supplies needed to effect these upgrades. The work can be done at the club or may be taken home for completion if you prefer.

Completing this kind of work will enhance the value and sale ability of all items when we attempt to sell them from our surplus inventory tables. Your work will help the club to raise more money for its operating budget and will be much appreciated.

We are looking for volunteers to work in this area. If you can help, please see or speak to Jerry Johnston. You can contact him at 207-966-2932 or email at jjchef@megalink.net.

CLUB DECORATING FOR CHRISTMAS SEASON

By Paul Lodge

On Monday, November 17, starting at 10 a.m., members are asked to help put up Christmas decorations in preparation for the ExTRAINaganza and for our annual Christmas party. We are looking forward to having each room sparkling. With many people decorating, there should be a variety of ideas to help make the club look more festive.

For the ExTRAINaganza, the Great Falls Model Railroad Club makes an effort to have our displays open during the same hours as the FEZtival of Trees sponsored by the Shriners in Lewiston. We want to make Lewiston/Auburn a fun destination for our out-of-town guests.

Come to the club at 10 a.m. on Monday, November 17, and get into the Christmas spirit with inspired decorating ideas for everyone to enjoy.

Bob Willard, People's Choice Winner



Larry Cannon presents Spate Award to Tom Coulombe



TOM COULOMBE RECEIVES ROBERT W. SPATE PUBLIC SERVICE AWARD

By Larry Cannon

On Saturday, October 18, Tom Coulombe was awarded the 2014 Robert W. Spate Public Service Award at the quarterly meeting of the Seacoast Division of the National Model Railroad Association (NMRA).

Tom has promoted the value of our hobby by sharing his life-long interest in railroading and model railroading with people of all ages. Those interactions include the Boy Scouts of America (BSA), the membership and visitors of the Great Falls Model Railroad Club of Auburn, Maine (GFMRRRC), the Seacoast Division NMRA, attendees of Operation Lifesaver International presentations (OLI), and others personally and publicly.

Tom has been involved with BSA in the Lewiston/Auburn area, Pine Tree Council, and Jamborees in various states. He has had a high level of involvement with the Railroading Merit Badge locally and regionally, for the Council, and for at least five national Boy Scout Jamborees.

Tom has a long history with the GFMRRRC and is currently Treasurer and Station Manager in his capacity as the facilities manager for the club's 40-foot by 75-foot two-level building. He is a past President of the organization and is active in the club's shows, open houses, and public displays, such as the one at the Amherst Society's Springfield Show where the club won the Best in Show Award this past winter.

Tom participates as an instructor in the club's long-established eight-week Model Railroading class held twice a year. While advertised and promoted as one of the Auburn Adult Education programs, about half of each class consists of children who have an interest in the hobby and are accompanied by adults.

Tom is also a videographer for the GFMRRRC's half-hour television program "Train Time", which is available and utilized by public access cable television stations throughout the United States. As of this time, 247 episodes have been produced and the library of programs has been accessed by 85 stations in 25 states.

Tom also serves as a presenter for Operation Lifesaver International (OLI), is a director and Treasurer for the Seacoast Division of NMRA, and is active in other Division activities.

The Robert W. Spate Public Service Award was started through a donation of \$1,000 from the Great Falls Model Railroad Club in 2001. Robert Spate of New Harbor, Maine, was a life member of the HUB Division of the Northeastern region, and actively shared his model railroading with young people and others interested in learning about the hobby. The estate of Robert W. Spate gave the Great Falls Model Railroad Club a very large donation of all of his model railroading materials, tools, and layout. This award honors Bob by recognizing others who share this spirit.

September Minutes by Paul Lodge



MEETING MINUTES OF

October 16, 2014

A Power Point slide show of club activities in September and October was shown from 6:45 to 7:00 p.m.

The evening's *TRAIN TIME* show featured a fall foliage trip on the Conway Scenic Railroad in New Hampshire.

President Jay Calnan opened the meeting and asked for the Secretary's Report. A motion was made to accept the report as published in the *Signal*. The minutes of the meeting from twenty years ago were summarized as a look back to appreciate some of the history of the club.

Tom Coulombe gave the Treasurer's Report, which was approved as given.

As Station Master, Tom Coulombe reported that the club has received glass shelving from Bob Hood. Shelves have been installed in the entrance storage room. Tom noted that the outside lights are not dependable. For safety reasons, he plans to have new LED lights installed so that they will come on automatically. Much of the cost of the new lights will be reimbursed by the Efficiency Maine program. The warning sensor in the oil tank needs to be replaced so that oil delivery people will know when the tanks are filled and we will not have a problem with oil overflowing. In the HO layout area, seven new step stools have been made so it will be easier for operators to see the upper levels. Tom noted that the speeder has been installed and the expense of the project was a donation by Mike Reed. Plexiglas doors will be installed on the rail car to keep out people who might get hurt. Tom reported that he picked up a large quantity of G-gauge rolling stock and buildings in Belmont, Massachusetts. The G-gauge group has chosen some items they want to use on the club layout. Ray Parent has volunteered to select some of the appropriate equipment and sell it on e-bay.

Terry King reported that an interesting donation was made by Tom Bamford, an Operation Lifesaver volunteer. His collection of artifacts included materials about railroad electrification on railroads in England, Uganda, and Pennsylvania.

The "Backdrop Painting for the Reluctant Painter" class has been rescheduled for Saturday, October 18, from 1 to 4 p.m., the same day as the annual meeting of Operation Lifesaver, which will run from 10 a.m. to noon.

Jerry Johnston proposed that club members can help the club earn more money by upgrading some of the donations we have received. Rolling stock can be improved and buildings can be rehabilitated so that they can be sold at higher prices. Tuesday evenings were chosen as the time to come to the club and work on improving these items. Some items can be taken home and worked on if club members feel more comfortable working alone at home.

Train Show: On Saturday, November 1, the annual train show at the Auburn Middle School will be held from 10 a.m. to 3 p.m. We have rented out about fifty tables so far. The club will have ten tables. It was estimated that we need a minimum of 23 people to help at the show. Members who wish to bring modules need to have them at Auburn Middle School before 8 a.m. in order to have them be part of the layout.

Travis Johnson reported that at the last operating session of the HO layout, 16 trains left for different locations and 12 successfully reached their destinations. He noted that there is room for more operators if club members are interested in coming to run trains. The next operating session is scheduled for Saturday, November 15, with an additional weekday operating session on Wednesday, November 19.

Paul Lodge asked for help in decorating the clubhouse for the ExTRAINaganza. Monday, November 17, from 10 a.m. to 2 p.m. is the time. He would like to assign different club locations for groups of people to decorate. New ideas for decorating and making the club look festive are among the goals for getting additional members to help. Tom Coulombe reported that Josh Stevens has volunteered to operate the N-scale layout during the ExTRAINaganza.

Members were reminded that the Modeler's Forum meets on the fourth Thursday each month.

On December 4, modules will be set up at the Maine State Museum for the display which will take place on Friday and Saturday, December 5 and 6.

Members were thanked for their participation in the Bottles for Basics and the drive for recycling used print cartridges.

The winning ticket was drawn for the 50/50 raffle. Ed Leslie won. Norm Ness won the attendance prize and selected a Lehigh Valley Hopper car.

The meeting adjourned.



TWELVE GIFTS OF CHRISTMAS

By Jerry Johnston

The Great Falls Model Railroad Club is holding a special fund-raising raffle this year in addition to our usual layout raffle. This raffle is quite different in that each ticket purchased will have **12 chances** to win any one of the prizes. If a ticket wins, it will be re-entered for all remaining drawings. The drawings are scheduled for Saturday, November 22, the last day of the ExTRAINaganza.

Prizes include a choice of an HO-scale diesel engine, a \$50 gift certificate to Governor's Restaurant or a \$50 gift certificate to Craft Mania. If you win a gift certificate and prefer cash, Jerry Johnston will purchase the gift certificate at face value and give you cash instead of the certificate.

Tickets are \$5.00 each or five for \$20.00. There is no limit to the quantity purchased.

We are asking that all club members purchase at least one ticket to help defray operating costs for the club. To purchase tickets and receive your ticket stub (s), see Jerry Johnston at a club meeting or operating session or send your money, name and address to:

Jerry Johnston: 554 Brighton Hill Rd. Minot, Maine 04258. For Info call 966-2932

FORUM NEXT MEETS IN JANUARY

By Paul Lodge

At the meeting on October 23, members of the Great Falls Modelers' Forum noted that the fourth Thursday for each of the next two months will be a holiday-- Thanksgiving and Christmas. As a result, the next get-together will be January 22.

It was suggested that other clubs and model railroad groups be invited to join us on the fourth Thursday of each month to share modeling ideas. Some other groups have indicated an interest. With more people contributing ideas, these sessions would be more useful for everyone.

Another idea mentioned at this month's Forum was the Clinic Day which we held several years ago. It was suggested that we could have three clinics at separate locations throughout the building. One group could meet in the library area; another, in the meeting room, and a third, downstairs in the classroom area. By charging registration fees, the Clinic Day could be a fund-raiser as well as a learning and teaching event. This concept fits into the education designation of the club's 501c(3) status.

CLUB DONATES

SPATE TRESTLE

By Paul Lodge

In 2001, Robert Spate's wife donated her husband's large HO layout to the club. One of the special features of his layout was a large hand-made wooden trestle. We were not able to use the trestle on the club's HO layout. Although the trestle has been taken to shows for many years, it has not been sold. At the annual train show at the Auburn Middle School on Saturday, November 1, a math teacher from Lewiston High School asked about the beautiful bridge. After some discussion, it was decided to donate the bridge so that it can be used by the Lewiston High School Math Department for geometry and other math-related projects.

Larry Cannon took the trestle home and spent several hours cleaning and restoring the bridge. This included rejoining the bent that had broken loose, shortening the track support timbers, repairing and replacing all the damaged parts, and extensive re-gluing. Larry said he used a lot of ACC to reinforce the structure. He also trimmed the trestle to make it a better display piece. Even though the trestle is light and fragile, it is a good example of bridge construction that can be used in math classes.

Larry and Terry King plan to create a display card which will indicate that the Spate trestle was donated by the Great Falls Model Railroad Club.

Spate Trestle after Restoration

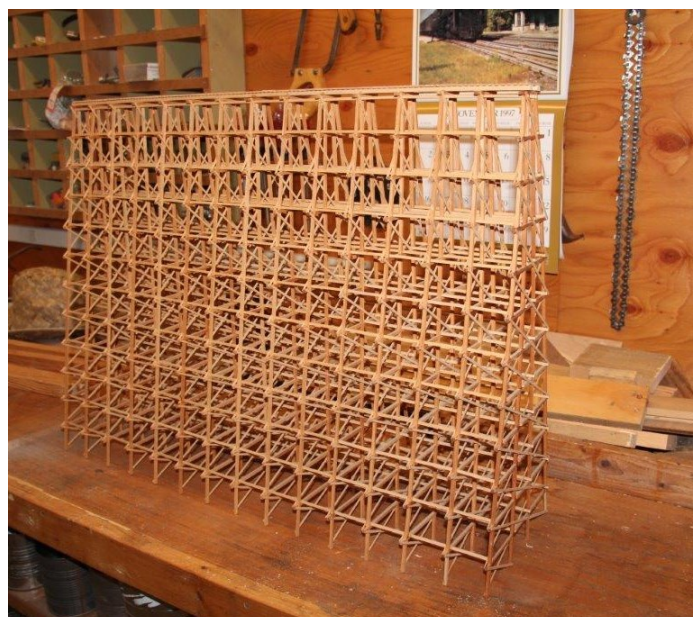



THE GREAT FALLS MODEL RAILROAD CLUB

144 Mill Street
Auburn, Me 04210

207-576-3788

e-mail:

greatfallsmodelrailroadclub@yahoo.com

An Educational Foundation

MEETING POSTPONEMENTS

If severe weather threatens on a meeting night, Tom Coulombe will notify local television stations that the meeting will be postponed until the following week. This would make it the fourth Thursday of the month instead of the third. Club members who receive the newsletter via e-mail will be notified by e-mail about the postponement.

OFFICERS:

President:

Jay Calnan-783-1719
jayceeltc@live.com

Vice President:

Roger Plummer

Secretary:

Paul Lodge - 966-3641
paul lodge@gwi.net

Treasurer:

Tom Coulombe - 240-9913
ctcoulombe@aol.com

Directors:

Roger Allen-783-2129
Travis Johnson-336-2789
slrmodlertj@aol.com

Darin Long

Webmaster:

Joe Marshall - 344-7099
joe@braintriggers.com
Assistant Webmaster:
Frances Lodge - 966-3641
paul lodge@gwi.net

Librarian/Archivist

Terry King
tpking@roadrunner.com

THE SIGNAL

The *Signal* is published twelve times per year by The Great Falls Model Railroad Club.

Copyright 2014

Editor:

Rick James
N1wfo@roadrunner.com

Proofreader:

Frances Lodge
paul lodge@gwi.net

Address Change

If your mailing or e-mail address changes please notify
Terrence King at
tpking@roadrunner.com

www.greatfallsmodelrrclub.org or www.gfmrrc.com

Upcoming Events



November 13, Board Meeting 6:30 p.m.
November 17, Christmas Decorating 10 - 2
November 20, Membership Meeting

ExTRAINaganza:

November 22, 10 a.m. to 8 p.m.
November 23, 10 a.m. to 4 p.m.
November 24, 4 p.m. to 8 p.m.
November 28, 10 a.m. to 8 p.m.
November 29, 10 a.m. to 4 p.m.
December 5-6, Maine State Museum
December 11, Board Meeting 6:30 p.m.

December 13, Surplus Asset Sale
8 a.m. to 5 p.m. at the club.

December 18, Membership Meeting
Club Christmas Party

September 7-10, 2016, 36th National
Narrow Gauge Convention at Augusta,
Me.

Terry King at AMS



Collette & Maurice Fortin

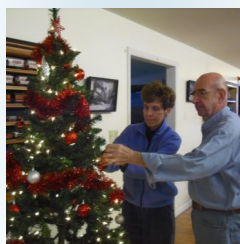

SURPLUS INVENTORY SALE

By Paul Lodge

On Saturday, December 13, club members and the general public will have an opportunity to purchase items from our surplus inventory from 8 a.m. to 5 p.m. at the club.

The inventory includes locomotives and rolling stock in all scales, as well as train sets, track, transformers, books, pictures and railroad memorabilia. Many buildings and other structures will be available to help build towns on a model railroad layout.

Since there is not enough room to house all of the surplus inventory at the club, many of these items have been stored by Tom Coulombe and will be available for the first time at this special sale.

December 13 was chosen as the date for our first Surplus Inventory Sale because it is so close to Christmas that it's an ideal time to purchase model railroad supplies as Christmas presents for children of all ages.